

Ana Mandara

—HUE, VIET NAM—

ANA MANDARA HUE BEACH RESORT & SPA

CONCEPT

Ana Mandara is Hues' first beach resort located 20 minutes from downtown Hue on the spectacular Thuan An Beach and Tam Giang Lagoon. This location offers guests a taste of "real" Vietnam. With the neighboring fishing village and lagoon one side and 400m of private beach.

Guests are welcomed into a wide spacious lobby with panoramic views over a reflection pond and beach. There are two-gourmet restaurants, wine lounge and pool bar. Hues' largest swimming pool and six treatment room dedicated spa, beauty salon and fitness centre. The total area of the Resort is 28,000 square meters (2.8 hectares) with a Beachfront of 400 meters.

Ana Mandara Hue delivers a liberating sense of space - our villas and guest's rooms are among Hue's largest. The resort consists of 78 rooms and villas scattered through 2.8 hectares of landscaped gardens. All villas and rooms are designed with the most modern and complete facilities.

Type	Number of room
DELUXE ROOM	48
DUPLEX ROOM	06
BEACH VILLA	20
POOL VILLA	04
Total	78

LOCATION

Ana Mandara Hue is located at the East of Hue City, at Thuan An village at the Thuan An Beach. The resort is a scenic 20-minute drive from down town hue, or 45 minutes from Hue airport.

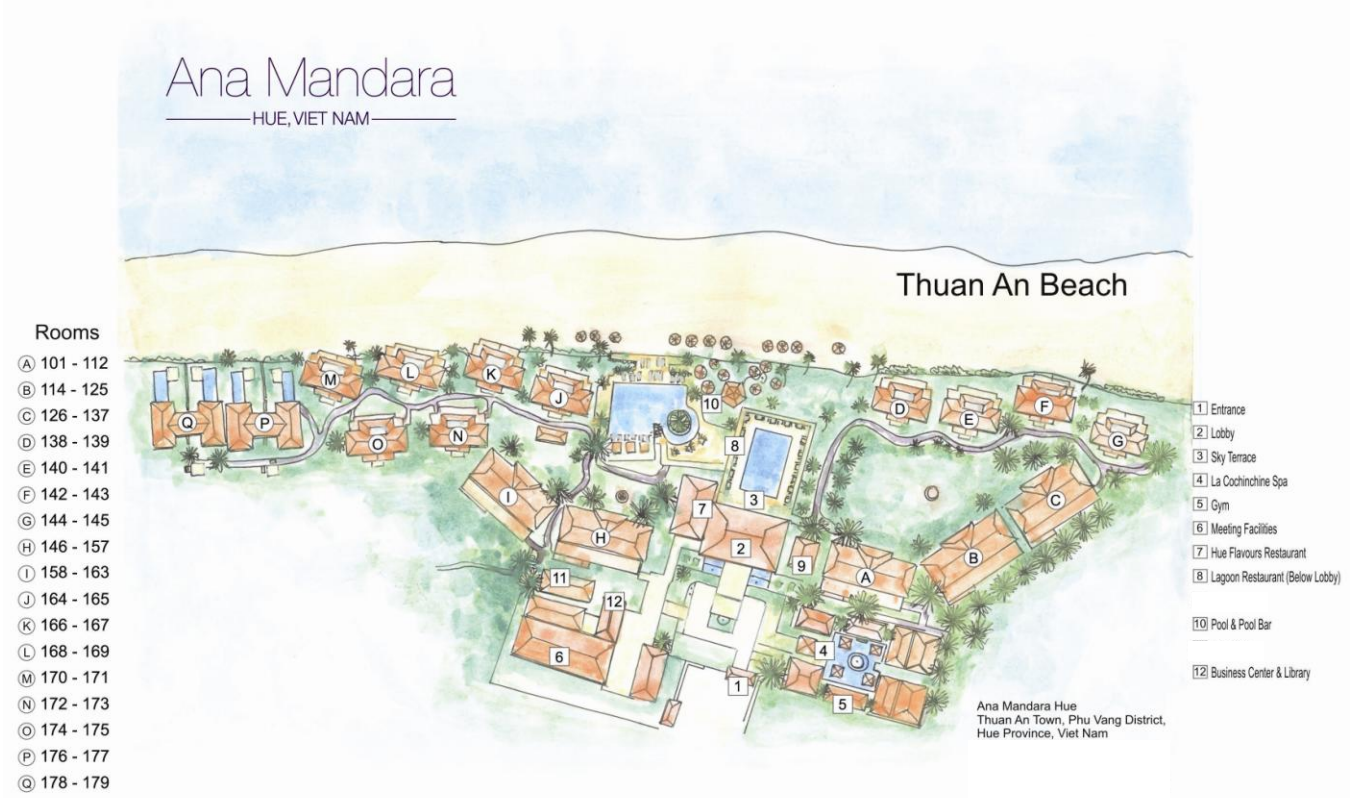

ACCOMMODATION

All guest rooms are based on 2 adults sharing. Double or Twin. Extra bed is available.

DELUXE ROOM (26 Double & 22 Twin)

48 Square meters. Double room, twin room or connecting room. Bathroom with shower, bathtub. Terrace in front or garden view.

DUPLEX ROOM (6 Double)

136 square metres of two storey living. Downstairs entertaining with pantry bathroom and covered terrace. Upstairs consists of master bedroom, large spacious bathroom and outdoor terrace. Ideal for families.

BEACH VILLA (18 Double & 2 Twin)

106 Square meters of space. With 48 square metres of indoor living and a 40 square metre terrace with sun lounges. Each villa has a separate bedroom, living room and indoor, outdoor bathroom. All villas are within 10 metres from the beach. 20 Double & 2 Twin.

POOL VILLA (4 Double)

Pool villas are 275 square meters. With 106 square metres of indoor living and a 48 square metre private pool. Each pool villa consists of 1 bedroom, living room, dressing area and indoor and outdoor bathrooms.

GUEST ROOMS FEATURES

All guest rooms feature:

Aircondition

Cable television

DVD player

Safe deposit Box

Private balcony

IDD telephone

Mini bar

Writing desk

Make-up table

Hair-dryer

Umbrella

In-room coffee, tea set

Electronic water pot

Flip Flops

Bathrobes

In villa dining

Turn-down service

Bathtub and shower

WIFI access

FLOOR PLANS

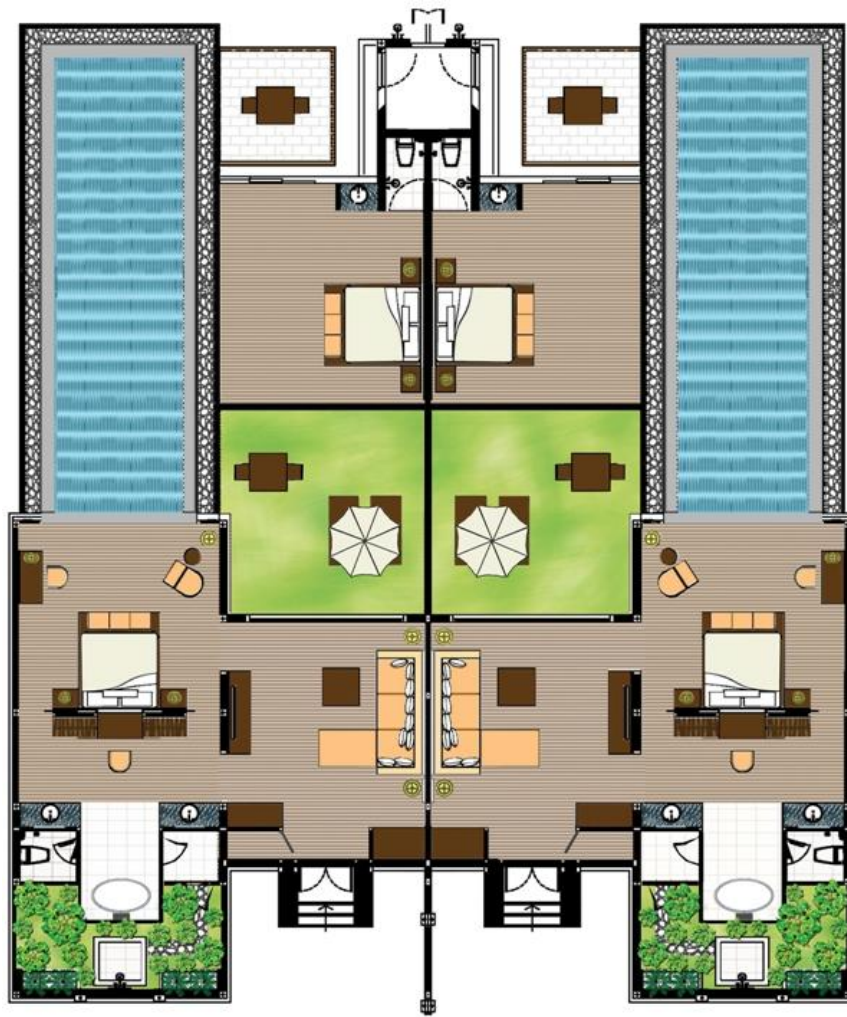

POOL VILLA



BEACH VILLA



DUPLEX UNIT

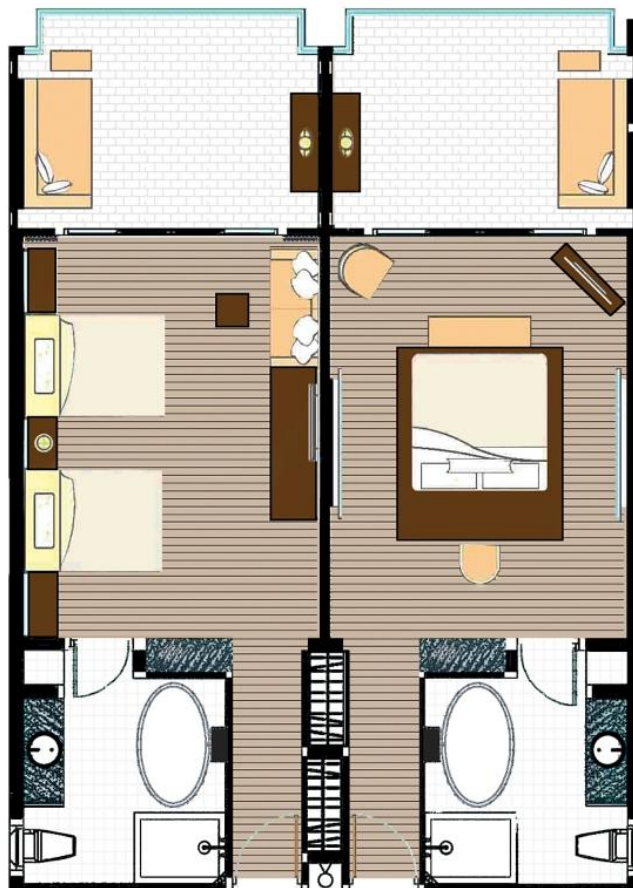

DELUXE

FOOD AND BEVERAGE FACILITIES

LAGOON RESTAURANT

Overlooking the beach, The Lagoon is the resort's main restaurant for breakfast and dinner.

Cuisine: Modern Bistro with international and Asian influences

Atmosphere: Asian inspired with Pool and Ocean Views. Surrounded with a shaded terrace for al fresco dining.

Hours: Breakfast: 6.30 – 10.00

Dinner: 17:30 – 22:00

HUE FLAVOUR

An intimate 30 seat restaurant and bar. With handcrafted daily menus specializing in the tastes of Vietnam and Hue. With an emphasis on fresh local seafood.

Cuisine: Traditional Hue & Regional Vietnamese

Atmosphere: Cozy and romantic with water features and adjoining bar.

Hours: Lunch and Bar: 11:00 - late

AQUA POOL BAR

Chill out and enjoy the sea breezes at our pool bar located between the beach and pool. Enjoy an icy cold beverage, cocktail or light snack. It's a nice place to relax.

Cuisine: Bar Menu

Atmosphere: Informal Tropical garden

Hours: 10:00 – 19:00

INSPIRED MEETINGS AND EVENTS

Offering 1,320 square meters of indoor and outdoor spaces, Ana Mandara Hue is the perfect location to mix business with pleasure. Whether it is a meeting, corporate gathering, presentation, training or team building event we can accommodate.

Facility	Sq.m
Main conference Hall	350
Breakout room – 1	100
Breakout room – 2	60
Breakout room – 3	60
Pre-function area	200
Outdoor terrace	220

GUEST SERVICE & FACILITIES

Pool towels, lounge chairs	Private gourmet dining
Handmade in room amenities	In villa dining
Tour desk	Beach and Pool service
Laundry Service	Pool/Beach bar
Resort parking	Wine lounge
Handicapped guest rooms	Private treatment rooms
Meeting & convention facilities (Max 300 pax)	WIFI
24 hours Reception & Security	Signature excursion
Fitness Room, steam and saunas	Cooking class

SPA AND FITNESS CENTRE

Ana Mandara Hue adds an extra touch of paradise with a comprehensive selection of delightfully indulgent treatments including various massage therapies, facials, exotic body scrubs and aromatherapy.

Total area including dressing and sauna and steam 500sq.mts

Facility	Rooms	Sq.m	Opening Hours
Beauty Saloon	1	60	9:00 – 21:00
Gymnasium	1	60	6:00 – 21:00
Treatment rooms	4	40	9:00 – 21:00
Mud bath	2	40	9:00 – 21:00

SWIMMING POOL

25-meter lap pool with adjoining kids pool, surrounded by gardens and lawns, with a sweeping views of the beach. Relax under the coconut trees or under your private poolside cabana. Or enjoy a chilled beverage or snack at our pool bar.

EXCURSIONS

You will never have a dull moment at Ana Mandara Hue, ask about our different trips to the neighboring villages in cyclo, cooking classes, fishing tours, water sports, or arrange a tour of the Ancient former capital city of Hue.

CONTACT INFORMATION

ANA MANDARA HUE BEACH RESORT & SPA

An Hai Village, Thuan An Town, Phu Vang District, Thua Thien Hue Province, Vietnam.

Tel: +84 234 398 33 33

Fax: +84 234 397 11 11

www.anamandarahue-resort.com

Email: sales@anamandarahue-resort.com